

FORM-7
[REGULATION-9]

Quarterly Progress Report for Quarter ending September- 2024

I. PARTICULARS OF PROMOTERS			
CIN NO.	U45309BR2017PTC033285	Name of Firm	Peopl Construction Private Limited
Firm Address:	Patner House, Basant Bihar Colony Boring Road, Patna, Patna, Bihar, India, 800001		
Total Experience of promoter in Real Estate Sector	10 Years		
Total Experience in Real Estate after Implementation of RERA			
No of Project done Before Implementation of RERA	1. Residential 2. Commercial 3. Residential- cum Commercial 4. Plotted project	Yes	
No of Project done After Implementation of RERA	1. Residential 2. Commercial 3. Residential- cum Commercial 4. Plotted project		

II. PARTICULARS OF PROJECT			
Project Registration Number	BRERAP00668-2/1292/R-1077/2020	Name of Project/Phase of Registered Project	PRAGYA'S SAVITRI ENCLAVE, PHASE-2
Name of Promoter	PANKAJ KUMAR	Project Address	NEAR T POINT, GOLA ROAD, DANAPUR, PATNA-801503
Name of Co-Promoter	KIRAN KUMARI, BRAJESH SINGH & UDAY KR SINHA		
Project Registration valid up to	21/09/2024		
Starting date of Project or Phase of the Project	21/12/2020		
Type of Project or Phase of the Project	Residential		

For Peopl Construction Pvt. Ltd.

Pankaj Kumar

Director

Period of validity of Map by the Competent Authority	21/09/2024		
--	------------	--	--

III. DISCLOSURE OF SOLD/BOOKED INVENTORY OF APARTMENTS					
Building/Block Number	Apartment Type	Carpet Area	Total Number of sanctioned apartments	Total Number of Apartments in Promoter's Share	Total Number of landowner's Share-
	1. 1 BHK-Nil 2. 2 BHK-12 3. 3 BHK-24 4. Shop-Nil 5. Bungalow- Nil 6. Plot etc- Nil	Nil 2928.0 8012.0 Nil Nil Nil	36	1. Booked/Allotted-16 2. Sold -0	3. Booked/Allotted - 4. Sold-
				Percentage of Booking	Percentage of Booking

IV. DISCLOSURE OF SOLD/BOOKD INVENTORY OF GARAGES		
Building/Block Number	Total Number of Sanctioned Garages	Total Number of Garages:
	36	1. Booked/Allotted -16 2. Sold- -0

V. DETAILS OF BUILDING APPROVALS					
(If already filed along with Registration Application, then there is no need of further filling)					
Sl.No.	Name of the Approval/N.O.C./Permission/Certificate	Issuing Authority	Applied date	Issuance Date	Enclosed as Annexure No.
1.	NOC for Environment	NA	NA	NA	NA
2.	Fire N.O.C.	Patna Bihar	10.04.2019	26.07.2019	2209
3.	Water Supply Permission	NA	NA	NA	NA
4.	NOC from Airport Authority of India	NA	NA	NA	NA
5.	Other Approval(S) if any, required for the Project	NIL	NIL	NIL	NIL

VI. CONSTRUCTION PROGRESS OF THE PROJECT	
1. Plan Case No.	(To beaded for each Building/Wing)

S.No.	Tasks/ Activity	Percentage of Actual	Expected Completion
-------	-----------------	----------------------	---------------------

For Peppi Construction Pvt. Ltd.

Ranjit Kumar

Director

(1)	(2)	Work Done (As on date of the Certificate) (3)	date in (dd/mm/yyyy) Format
1.	Excavation	100%	
2.	Basement (if any)	NA	
3.	Podiums (if any)	0%	
4.	Plinth	100%	
5.	Stilt Floor	80%	
6.	Slabs of Super Structure	100%	
7.	Internal walls, internal Plaster, Flooring, Doors and Windows within Flats/ Premises.	80%	
8.	Sanitary Fitting within the Flat/Premises, Electrical Fittings within the Flat/Premises	60%	
9.	Staircases, Lifts Wells and Lobbies at each Floor level, Overhead and Underground Water Tanks	70%	
10.	External plumbing and external plaster, elevation, completion of terraces with waterproofing of the Building/ Wing.	60%	
11.	Installation of Lifts, water pumps, Fire Fighting Fitting and Equipments as per CFO NOC, Electrical fitting, Mechanical Equipment, compliance to conditions of environment/ CRZ NOC, Finishing to entrance lobby/s, plinth protection, paving of areas appurtenant to Building/ Wing, Compound Wall and all other requirements as my be required to complete project as per specifications in Agreement of Sale. Any other activities.	0%	

VII. Amenities and Common Area and External Infrastructure Development Works)				
S.No.	Common Areas and Facilities	Proposed (Yes/No)	Percentage of actual Work Done(As on date of the Certificate)	Expected Completion date in (dd/mm/yyyy) Format
(1)	(2)	(3)	(4)	(5)
1.	Internal Roads & Footpaths	Yes	0%	
2.	Water Supply	Yes	0%	
3.	Sewerage (Chamber, Line, Septic Tank, STP)	Yes	0%	

For Peppi Construction Pvt. Ltd.

Rameoj Kumar

Director

4.	Storm Water Drains	Yes	0%	
5.	Landscaping & Tree Planting	No	NA	
6.	Street Lighting	Yes	0%	
7.	Community Building	No	NA	
8.	Treatment and Disposal of Sewage and Sullage Water	Yes	0%	
9.	Solid Waste Management & Disposal	No	NA	
10.	Water Conservation/ Rain Water Harvesting	Yes	0%	
11.	Energy Management	Yes	0%	
12.	Fire Protection and Fire Safety Requirements	Yes	0%	
13.	Closed Parking	Yes	0%	
14.	Open Parking	No	NA	
15.	Electrical Meter Room, Sub-Station, Receiving Station	Yes	0%	
16.	Others (Option to Add More)	No	NA	

VIII. A EXTERNAL AND INTERNAL DEVELOPMENT WORKS IN CASE OF PLOTTED DEVELOPMENT

SL.NO.	PARTICULARS	PROPOSED YES/NO	PERCENTAGE OF ACTUAL WORK DONE (As on date of Certificate)	Expected Completion date in (dd/mm/yyyy) Format
1.	Internal Roads and foot paths			
2.	Water Supply			
3.	Sewerage Chambers Septic Tank			
4.	Drains			
5.	Parks, Land Scaping and Tree Planting			
6.	Street Lighting			
7.	Disposal of Sewage & Sullage Water			
8.	Water Conservation/Rain water Harvesting			
9.	Energy Management			

IX. GEO TAGGED AND DATE PHOTOGRAP OF THE BLOCKS (EACH BLOCK) OF THE PROJECT

(A). - S.No.	Particulars
1.	Front Elevation

For Peopl Construction Pvt. Ltd.

Ranjit Kumar

Director



2. Rear Elevation



For Peppi Construction Pvt. Ltd.

Ranjit Kumar

Director

3. Side Elevation

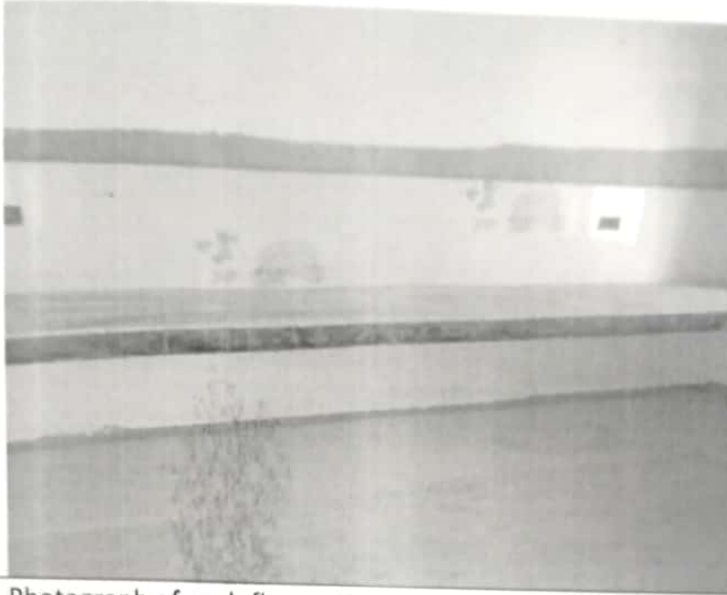

(B) Photograph of each floor – N. A.

X. Financial Progress of the Project

S.No.	Particulars	Amount (in Rs.)
(1)	(2)	(3)
1.	Project Account No.	1. ICICI Bank(A/c No.-040405008804 2. ICICI Bank(A/c No.-040405008808 3. ICICI Bank(A/c No.-040405008805
2.	Estimated Cost of the Project including land cost at the start of the Quarter	Estimated Cost-6,60,00,000.00 and Land Cost 2,60,00,000.00
3.	Amount received during the Quarter	0.00
4.	Actual Cost Incurred during the Quarter	1,01,791.08
5.	Net amount end of the Quarter	1,028.70
6.	Total expenditure on Project till date	5,73,08,291.90
7.	Cumulative fund collected till the end of Quarter in question	4,04,82,107.00
8.	Cumulative Expenditure done till the end of Quarter in question	5,73,08,291.90

XI. DETAILS OF MORTGAGE OR CHARGES IF ANY CREATED

XII. MISCELLANEOUS

A.	List of Legal Cases (in any)
1.	Case NO. Nil

For Peopl Construction Pvt. Ltd.

Director

2.	Name of Parties	Nil
B	Sale/ Agreement for Sale during the Quarter	Nil
1.	Sale Deed	Nil
2.	Agreement for Sale	16

XIII. PERCENTAGE OF WORK ALONG WITH MILESTONE CHART

SCHEDULE 'C' PAYMENT PLAN

The consideration amount will be paid as per the Following schedule.

1. At the time of booking/Agreement –	10%
2. Starting of Foundation-	20%
3. On Casting of First Floor-	20%
4. On Casting of Second Floor -	20%
5. On Casting of Third Floor –	15%
6. On Casting of Fourth Floor -	10%
7. At the time of Possession-	05%

Weather the project In progress is as per time schedule or lagging behind?

Undertaking:

I/We solemnly affirm, declare and undertake that all the details stated above are true to the best of my knowledge and nothing material has been concealed here from. I am/we are executing this undertaking to attest to the truth of all the foregoing and to apprise the Authority of such facts as mentioned as well as for whatever other legal purpose this undertaking may serve.

Signature of Promoter

For Peopl Construction Pvt. Ltd.

Name: Pankaj Kumar

Pankaj Kumar

Date : 13.11.2024

Director